

新海街道西南经联社韩津路以东、太湖路以南集体划留用地宗地草图

(单位: 米 平方米)

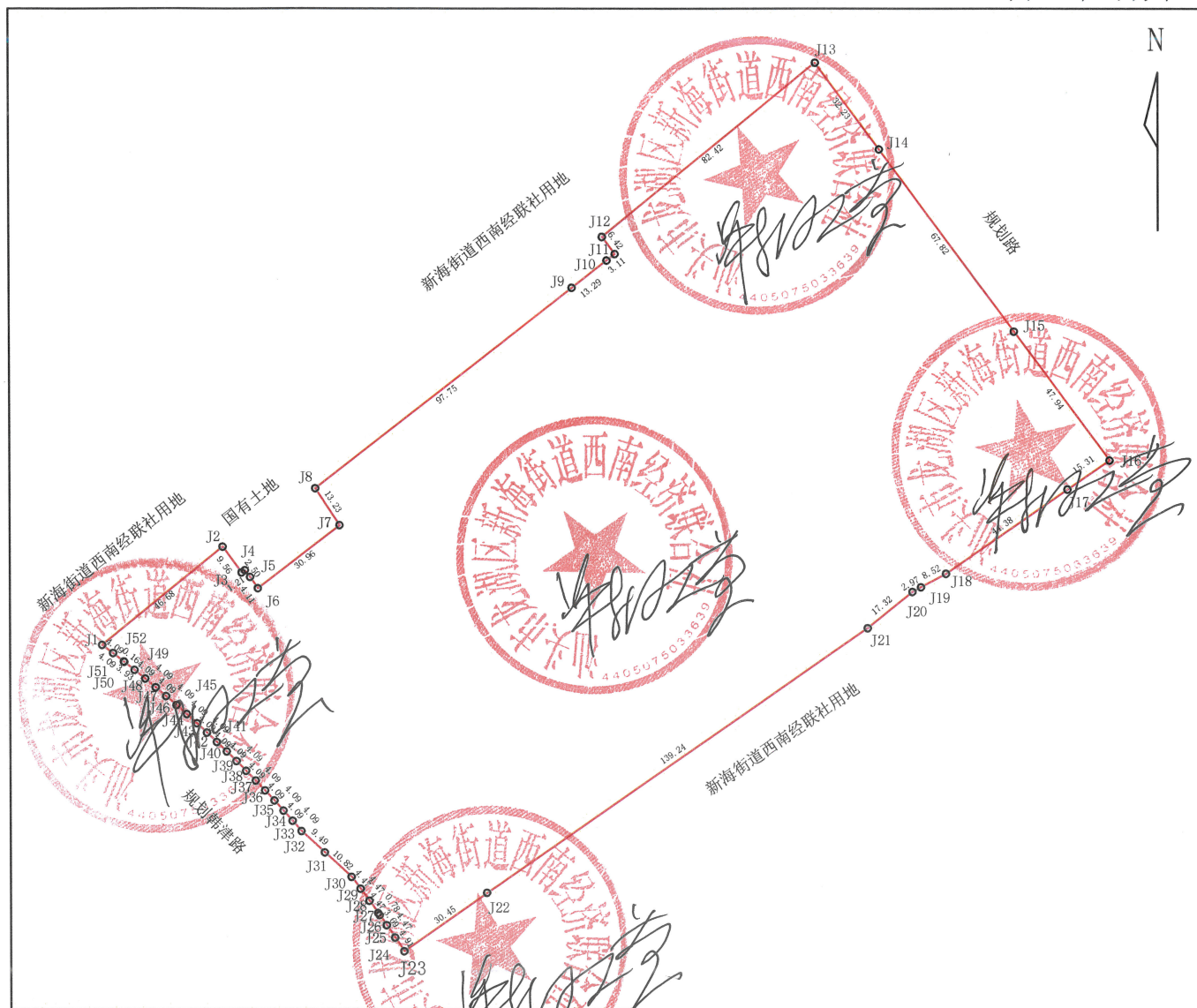

界址点坐标表

点号	X	Y	点号	X	Y
J1	2585477.481	39476561.728	J27	2585397.224	39476644.292
J2	2585506.930	39476597.945	J28	2585400.852	39476641.678
J3	2585499.213	39476603.596	J29	2585404.449	39476639.021
J4	2585499.890	39476604.604	J30	2585408.014	39476636.321
J5	2585497.901	39476606.112	J31	2585415.318	39476628.343
J6	2585494.514	39476608.448	J32	2585421.729	39476621.340
J7	2585513.335	39476633.026	J33	2585424.820	39476618.663
J8	2585524.405	39476625.787	J34	2585427.881	39476615.951
J9	2585584.462	39476702.915	J35	2585430.912	39476613.206
J10	2585592.630	39476713.405	J36	2585433.913	39476610.428
J11	2585594.539	39476715.855	J37	2585436.882	39476607.616
J12	2585599.692	39476712.029	J38	2585439.821	39476604.772
J13	2585651.692	39476775.980	J39	2585442.727	39476601.896
J14	2585625.813	39476795.191	J40	2585445.602	39476598.987
J15	2585571.359	39476835.614	J41	2585448.444	39476596.047
J16	2585532.868	39476864.188	J42	2585451.254	39476593.076
J17	2585524.162	39476851.589	J43	2585454.031	39476590.074
J18	2585498.930	39476815.074	J44	2585456.774	39476587.042
J19	2585494.895	39476807.568	J45	2585459.484	39476583.979
J20	2585493.491	39476804.954	J46	2585462.160	39476580.887
J21	2585482.618	39476791.468	J47	2585464.801	39476577.765
J22	2585403.348	39476676.993	J48	2585467.408	39476574.614
J23	2585385.788	39476652.114	J49	2585469.979	39476571.434
J24	2585389.874	39476649.388	J50	2585472.416	39476568.353
J25	2585393.564	39476646.862	J51	2585472.516	39476568.227
J26	2585396.583	39476644.742	J52	2585475.017	39476564.991

委托单位: 龙湖区新海街道西南经联社
 红线内用地面积: 35196.14平方米, 合52.794亩。
 制图依据: 汕龙自然资地[2024]4号文。
 说明: 本图仅用于权籍调查。

